

**PRODUCT REGISTRATION:**

MAKE SURE TO REGISTER YOUR PURCHASE AT  
<https://allen.bike/pages/register-your-product>  
 TO QUALIFY FOR PRODUCT WARRANTY AND  
 TO RECEIVE IMPORTANT PRODUCT NOTIFICATIONS

# MODEL SB-01 SMART SUCTION 1-BIKE RACK

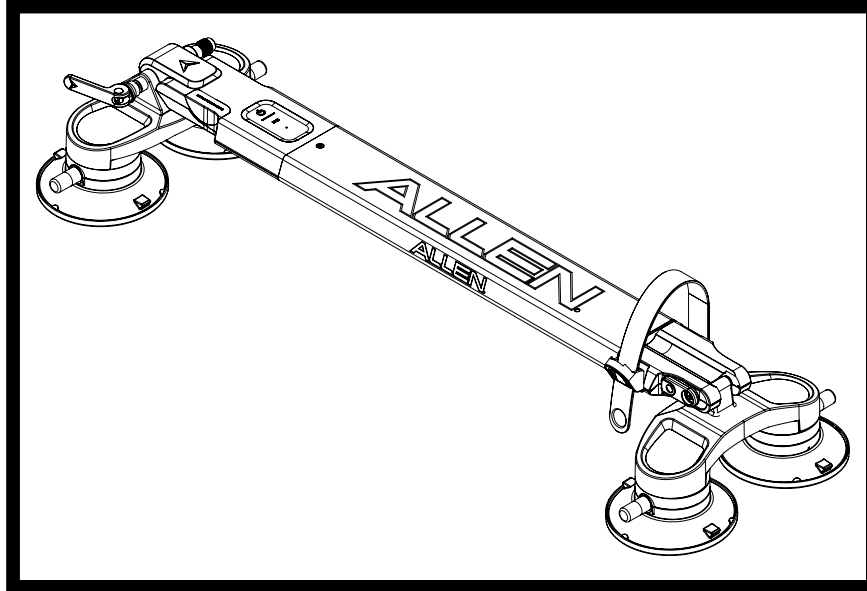

## Owner's Manual should be kept for future reference

1. Completely read and understand Owner's Manual before assembling or operating this product.
2. This product should be assembled by an adult.



### WARNING:

**Bicycles or rack falling in road can cause serious accidents resulting in bodily injury!! Do not use rack on any vehicle on which it can't be properly mounted as described in this instruction sheet.**

- NEVER MOUNT BICYCLE ON VEHICLE SIDWAYS OR AT ANY ANGLE THAT IS NOT PARALLEL WITH THE CENTERLINE OF VEHICLE. NEVER MOUNT THE BICYCLE FACING BACKWARDS.
- MAX ALLOWABLE BIKE WEIGHT: 35 LB (18 KG), AND WHEELBASE LENGTH OF 35.5" (900mm) TO 52" (1320mm).
- NEVER EXCEED POSTED SPEED LIMIT.
- NEVER USE PRODUCT IF ANY PART IS DAMAGED OR MALFUNCTIONING, OR IF ANY SUCTION CUP IS UNABLE TO MAINTAIN FULL VACUUM FOR AT LEAST FOUR HOURS.
- ALWAYS CLEAN SMART SUCTION CUPS AND MOUNTING SURFACE OF VEHICLE BEFORE USING PRODUCT. ANY INTERFERENCE OR DEBRIS BETWEEN SUCTION CUP AND MOUNTING SURFACE CAN IMPACT RACK'S ATTACHMENT AND PERFORMANCE.
- DO NOT USE PRODUCT IF ANY SUCTION CUP IS NOT AT FULL SUCTION, AS INDICATED BY INDICATOR BAND ON THE PUMP - NO RED SHOULD SHOW AT PROPER SUCTION. REGULARLY CHECK INDICATOR BANDS ON SUCTION CUPS DURING USE.
- FORK MOUNT AND REAR WHEEL STRAP MUST BE CORRECTLY INSTALLED AND TIGHTENED TO PROPERLY CARRY THE BICYCLE. REGULARLY CHECK DURING USE TO CONFIRM THAT THE FORK MOUNT AND WHEEL STRAP ARE TIGHT AND BICYCLE IS SECURE.
- CONTACT CUSTOMERSERVICE@ALLEN.BIKE FOR ANY QUESTIONS OR REPLACEMENT PARTS.



### CAUTION:

**Only use Smart Suction Rack in accordance with local motor vehicle and traffic regulations**

- ONLY INSTALL RACK AND LOAD BICYCLES AT A SAFE DISTANCE AWAY FROM MOVING TRAFFIC.
- INSTALLED BICYCLES SHOULD NEVER EXTEND BEYOND SIDE OF THE VEHICLE DURING TRANSPORT.
- MOUNT RACK ON THE PART OF THE ROOF THAT IS LEAST FLEXIBLE, SUCH AS JUST BEHIND THE FRONT WINDSHIELD.
- STRENGTH AND SUITABILITY OF GLASS PANORAMIC ROOF OR GLASS SUNROOF SHOULD BE VERIFIED BEFORE INSTALLING RACK ONTO THIS SURFACE.
- REMOVE RACK FROM VEHICLE WHEN NOT IN USE.
- DO NOT DISCARD PROTECTIVE COVERS; PROTECTIVE COVERS SHOULD BE CORRECTLY INSTALLED ON VACUUM CUPS WHEN THE RACK IS NOT BEING USED.
- INSPECT, CLEAN, AND LUBRICATE SMART SUCTION PUMPS REGULARLY TO MAINTAIN PEAK RACK PERFORMANCE.
- SMART SUCTION RACK SHOULD ALWAYS BE USED IN CONJUNCTION WITH THE ALLEN APP.



**Max 35 lbs.**

**Min. Wheel Base 35.5in (902mm)**

**Max. Wheel Base 52in (1320mm)**

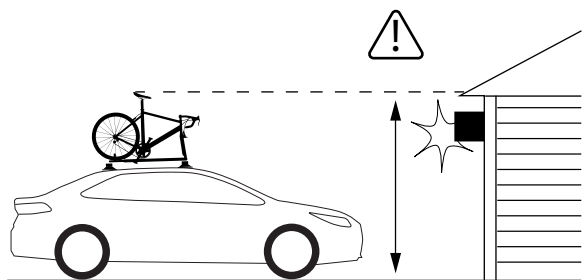
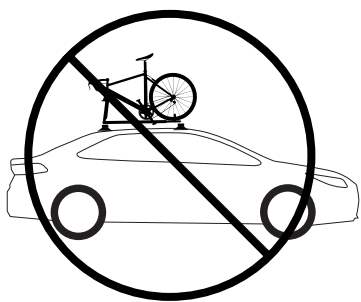
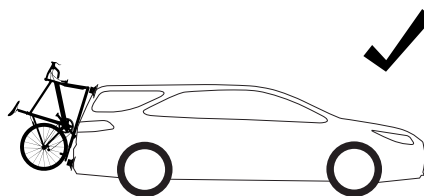
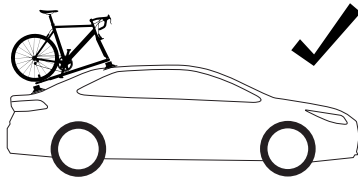
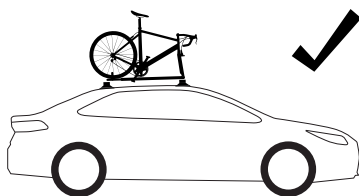

**Warning: Do Not park vehicle in Garage  
with Rack or Bicycles installed on vehicle**

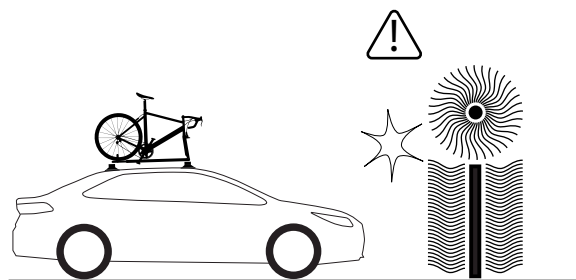

**Warning: Never enter Car Wash with  
Rack or Bicycles installed on vehicle**

## PARTS LIST

\* drawings not to scale

1

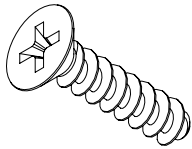

3X - M4 18mm Flathead Screw

2

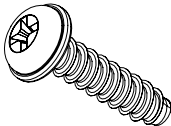

2X - M3 12mm Washer Head Screw

3

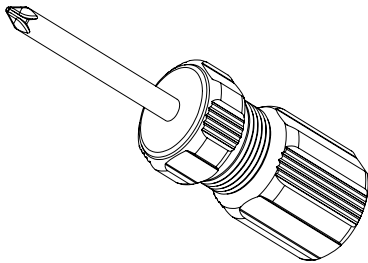

1X - Small Phillips Head Screwdriver

5

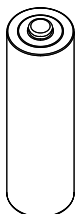

4X - AA Batteries  
\* NOT INCLUDED

6

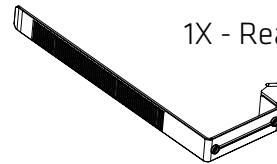

1X - Rear Wheel Strap

7

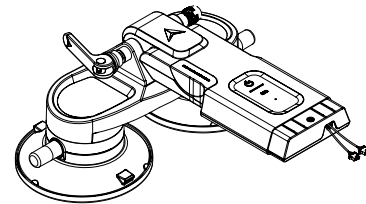

1X - Front Unit Assembly

8

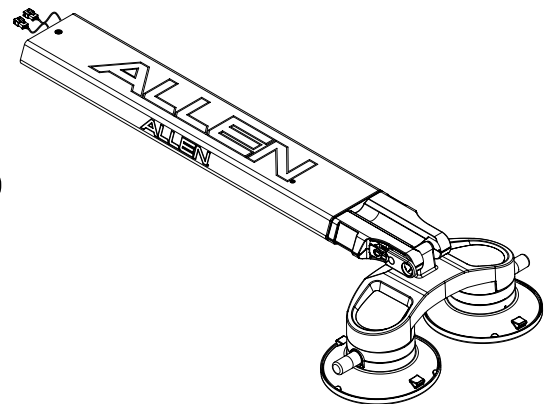

1X - Rear Unit Assembly

9

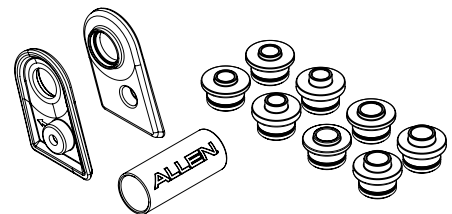

1X - Front Axle Adapter Set



## ASSEMBLY INSTRUCTIONS

**STEP 1:** Lay out the Front Unit Assembly and the Rear Unit Assembly as pictured in **Figure 1** so the ends are parallel. Confirm that the cable connectors are exposed out of the rear section of the device.

**Tools Required: NONE**

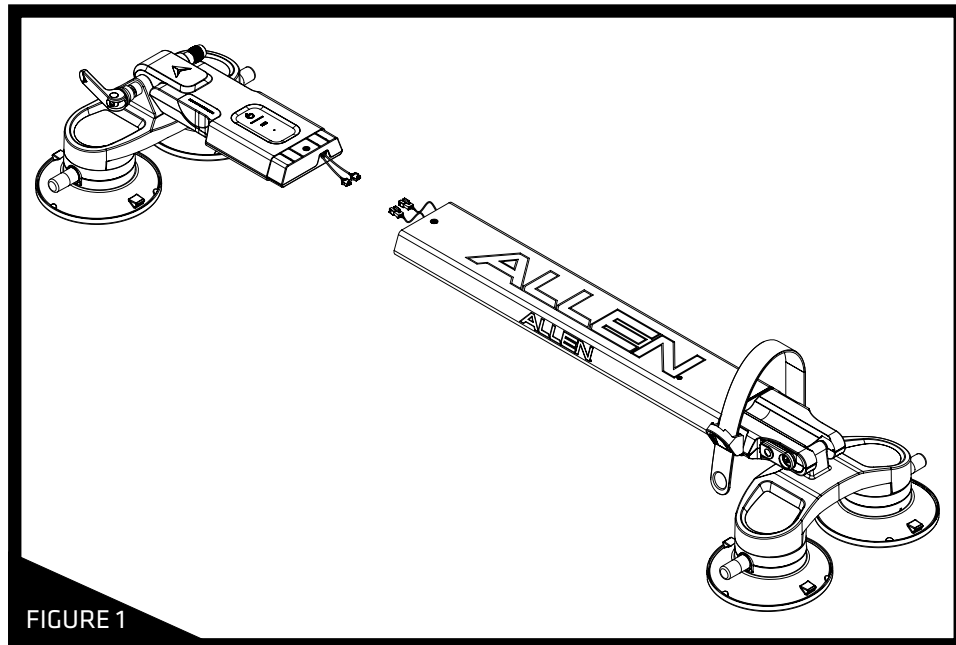

FIGURE 1

**STEP 2:** Attach the male and female wire connectors as shown in **Figure 2**. There should be an audible **CLICK** when the cables are properly attached.

**Tools Required: NONE**

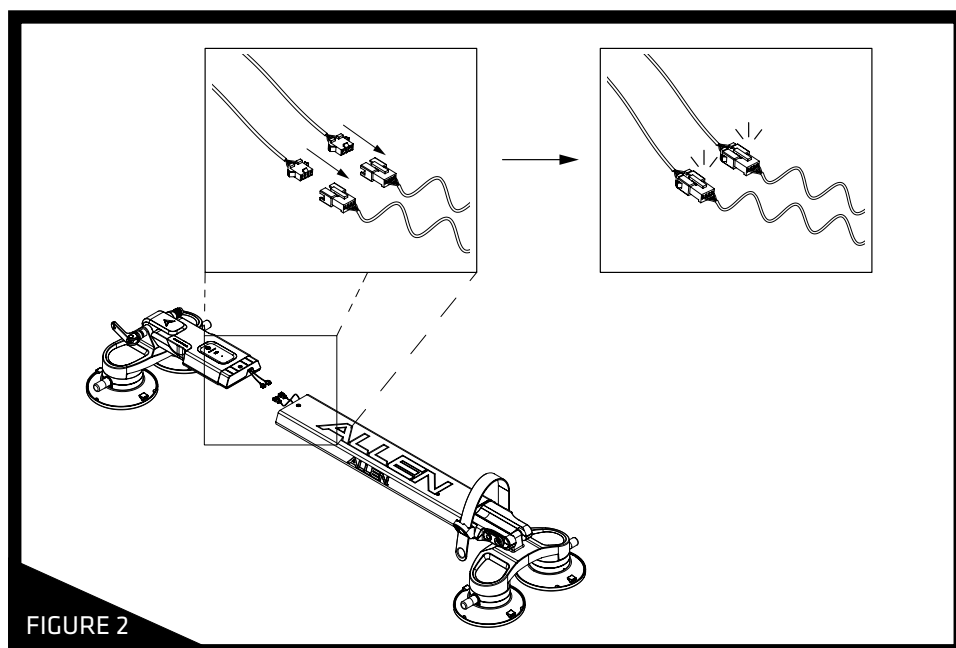

FIGURE 2



**STEP 3:** Slide the frame of the Rear Unit Assembly over the Front Unit Assembly as shown in Figure 3.

**Tools Required: NONE**

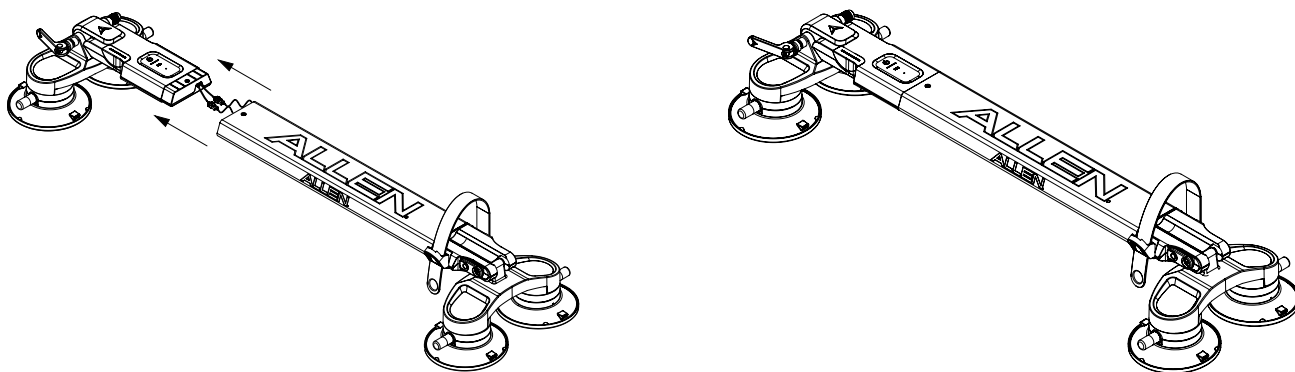
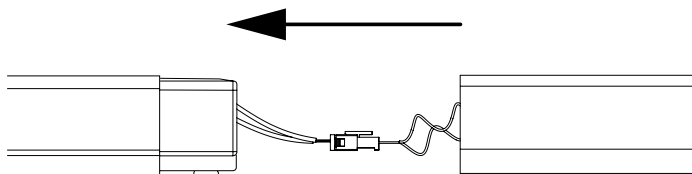
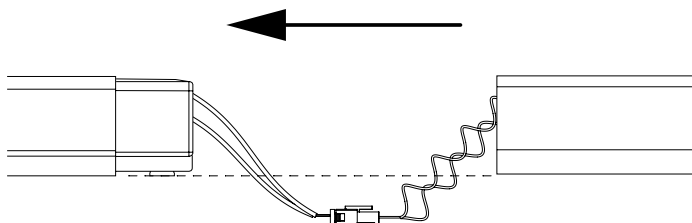
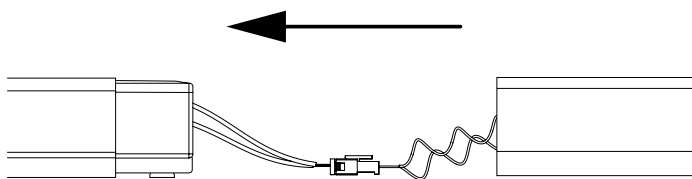

FIGURE 3

**Warning!** Ensure that the cables do not get pinched during this process and are safely stowed inside of the device.





**STEP 4:** Confirm that the holes in the metal frame and the plastic front housing line up. Secure the two sections with 3X - M4 18mm Flathead Screws (included) with the Philips Driver as shown in **Figure 4**.

**NOTE:** Ensure that the TOP and BOTTOM are fastened as shown in the diagram below.

**Tools Required:**

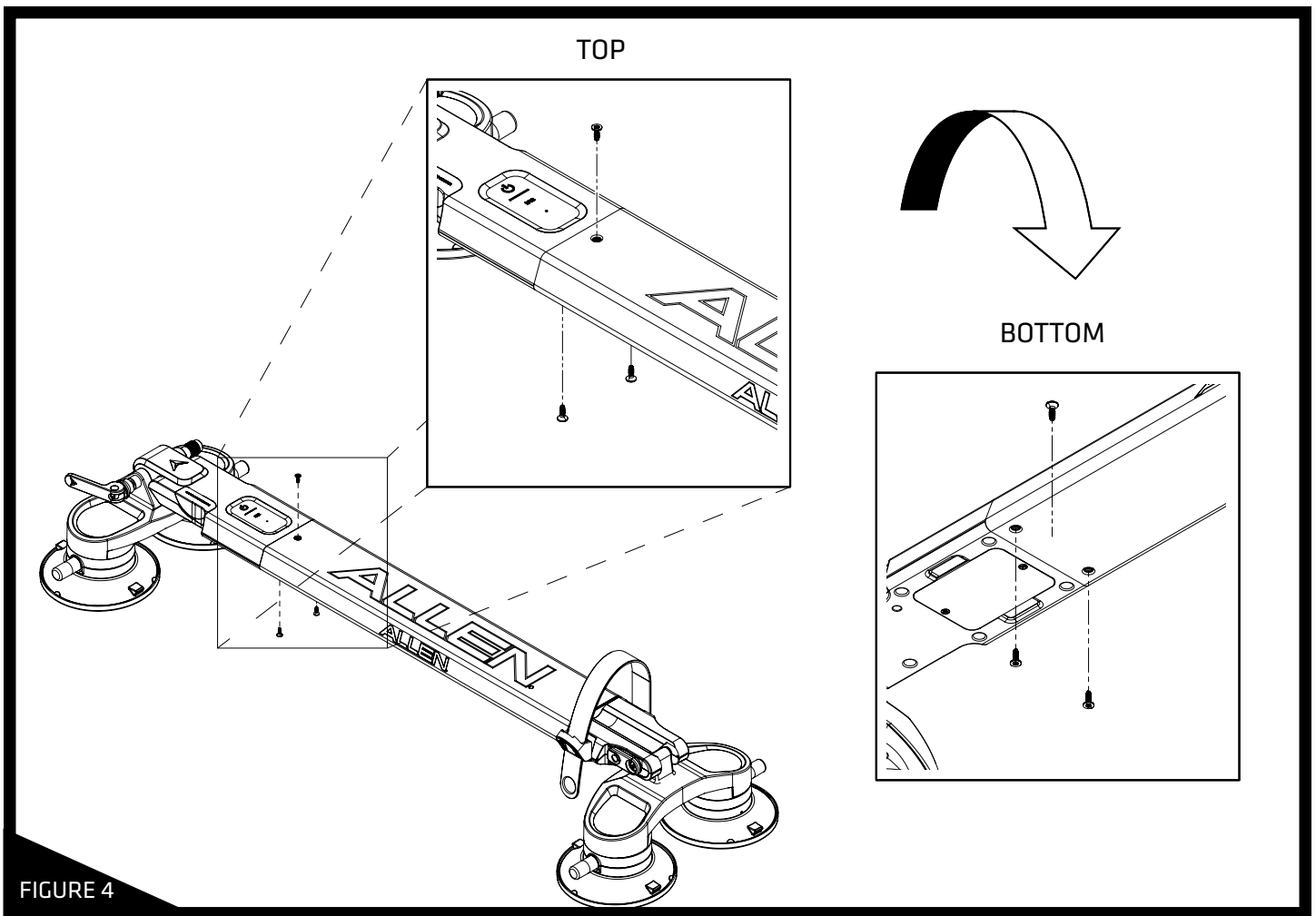



**STEP 5:** Remove the battery access panel on the underside of the rack and keep the screws on hand as shown in **Figure 5**. Insert 4x - AA Batteries (**NOT INCLUDED**) according to the instructions marked on the rack. Replace the access panel and secure with the screws.

**Tools Required: Small Phillips Head Screwdriver (NOT INCLUDED)**

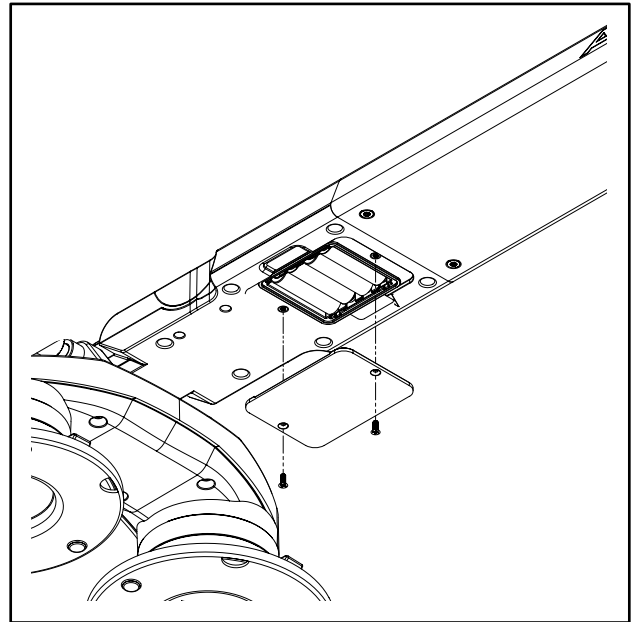
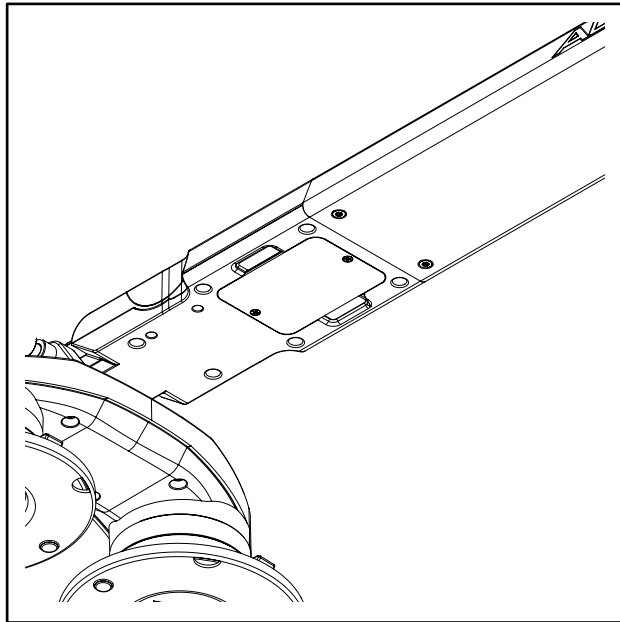

FIGURE 5



**STEP 6:** Locate the Rear Wheel Strap in the Box. Use the Phillips Head Screw Driver (included) to attach the Rear Wheel Strap with the 2X - M3 12mm Washer Head Screws provided on the bottom of the Rear Unit Assembly as shown in **Figure 6**. Place the strap from the bottom with the strap facing upwards in the preferred orientation and ensure that the holes are lined up with the holes in the Rear Unit Assembly. Secure with 2X - M3 12mm Washer Screws provided. Feed the end of the ratchet strap through the top of the buckle on the opposite side.

**NOTE:** The Rear Wheel Strap can be mounted either in a right or left orientation. Mount the Rear Wheel Strap based on whether you will be accessing the rack from the left or right side of your vehicle.

### Tools Required:

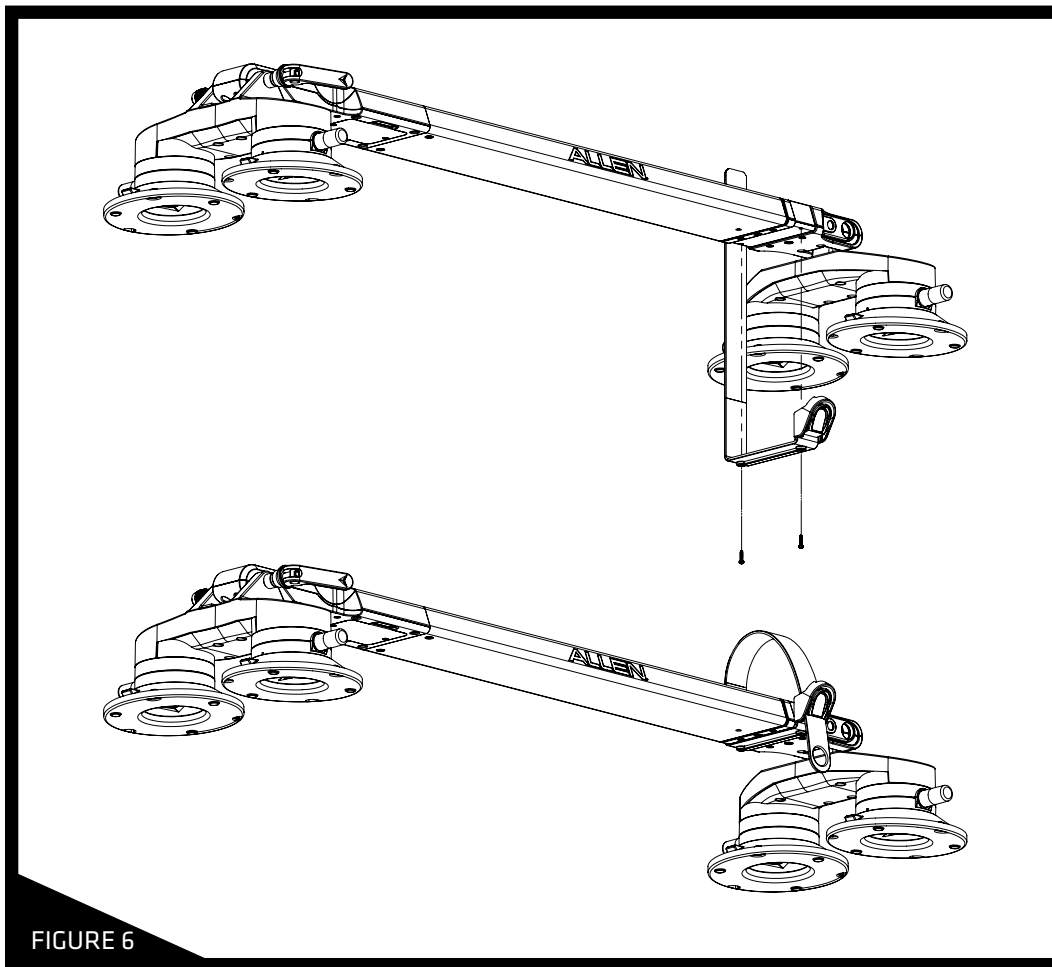

FIGURE 6





**STEP 7:** Install Allen Sports App by scanning the QR Code below.

**Tools Required: Smartphone (NOT INCLUDED)**





# ALLEN

## INSTRUCTIONAL OWNER'S MANUAL

# 10

**STEP 8:** Pair the Smart Suction Bike Rack with the Allen Sports App. Ensure your mobile device has Bluetooth turned on and is in range of your bike rack. Sign in to the app using your existing account. If it's your first time, sign up to create a new account. Press and release the power button to turn on the rack, as shown in **Figure 7**. The status light should begin flashing. Add the bike rack to your devices by tapping the plus icon at the bottom of the home screen. Tap the connect button to begin pairing. The light should change from flashing to solid when rack is paired.

**STEP 9:** Refer to the app for live updates of the suction system. The app will notify if any of the suction cups drop below the minimum pressure threshold. If you receive notifications that the suction cups have lost pressure, pump the suction cup plunger until the red band is no longer visible.

**NOTE:** If there is continued loss of pressure, discontinue use of the rack and refer to the trouble shooting guide for further assistance.

**Tools Required: Smart Phone (NOT INCLUDED)**

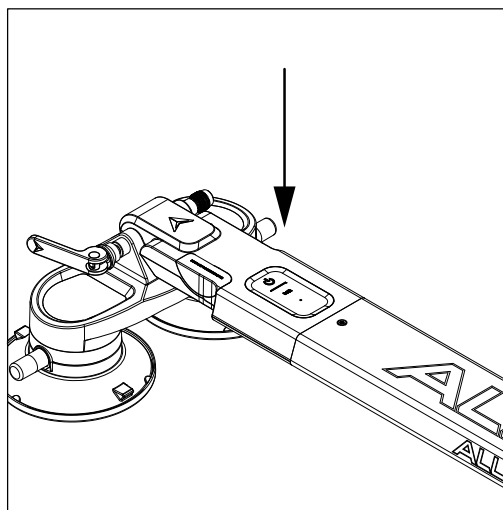
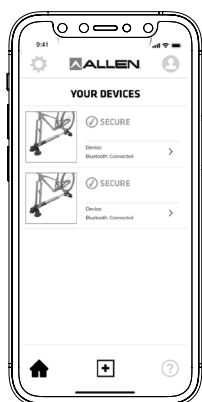

FIGURE 7

FOR QUESTIONS REGARDING WARRANTY SERVICE, ASSEMBLY, INSTALLATION, OR  
USE, PLEASE CONTACT

ALLEN SPORTS USA  
CUSTOMERSERVICE@ALLEN.BIKE

Please note that all returns and exchanges are subject to the return policy of the retailer where the product was originally purchased



# ALLEN

R.A. ALLEN CO., INC. - 500 Beachland Blvd., Suite 1 - 1002; Vero Beach, FL 32963 - USA  
customerservice@allen.bike

www.allen.bike

Product Designed in USA, Made in Shanghai, China



## RACK ADJUSTMENT INSTRUCTIONS

**STEP 1:** Adjust the rack length to fit bike size as shown in **Figure 8**. Set the fully assembled rack on the ground near the vehicle. Remove the front wheel of the bike. Align the fork of the bike with the skewer component on the front section of the rack. Pull the rear section of the rack out until the bottom of the wheel lines up with the tire tray and rear wheel strap on the rear section of the rack. The rack is now set to the correct length to properly secure the bike. Front axle of bike does not have to fit at this point.

**NOTE:** For future reference, take note of the measurement on the red metal beam that is indicated for your bike.

**IMPORTANT:** Do Not Mount the Rear Wheel in between the Red Extension Bars (Figure 9)

Tools Required: NONE

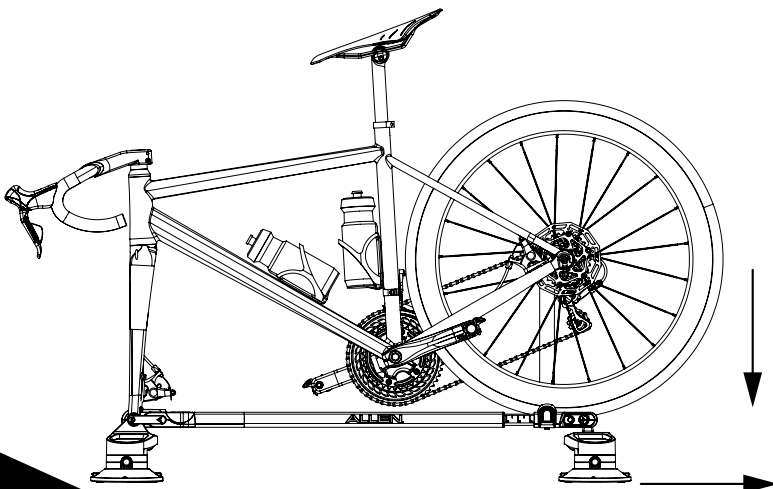
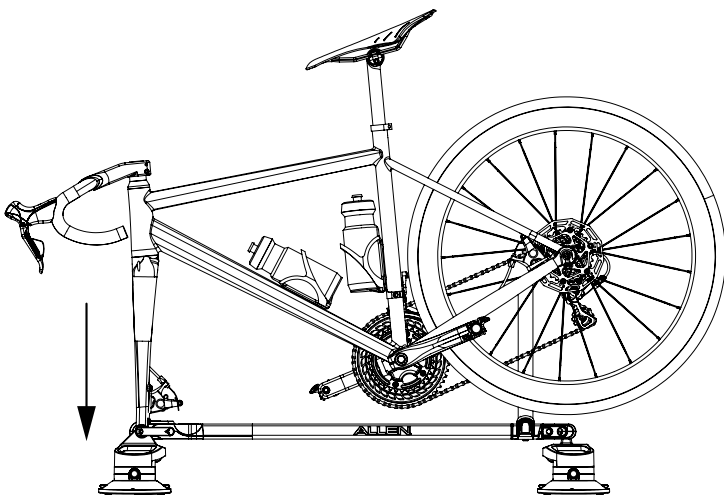
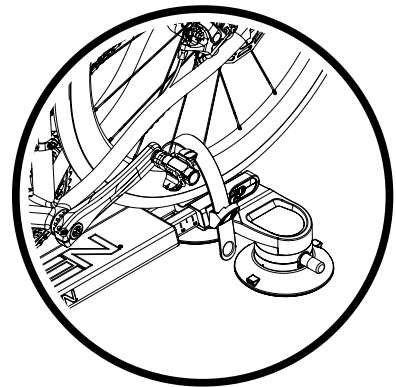

FIGURE 8

**CORRECT**



**INCORRECT**

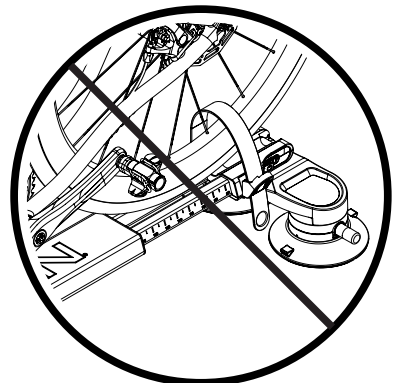

FIGURE 9



**STEP 2:** Determine bike type for best installation.

- For road bikes with Disc Caliper Brakes, *proceed to step 3*
- For road bikes without Disc Caliper Brakes, *skip to step 4*
- For all other bikes, *skip to step 5*

**STEP 3:** *For road bikes with Disc Caliper Brakes.*

Remove the Plastic Cap labeled "REMOVE FOR DISC CALIPER" on the front of the rack assembly as shown in **Figure 10**. Locate the screws on the underside of the rack that hold the plastic cap in place and remove them using a Small Phillips Head Screwdriver (**NOT INCLUDED**).

**IMPORTANT:** Do Not Remove Red Suction Cup Covers until instructed (**page 18**).

**NOTE:** Store the Plastic Cap for later use.

**Tools Required:** Small Phillips Head Screwdriver (**NOT INCLUDED**)

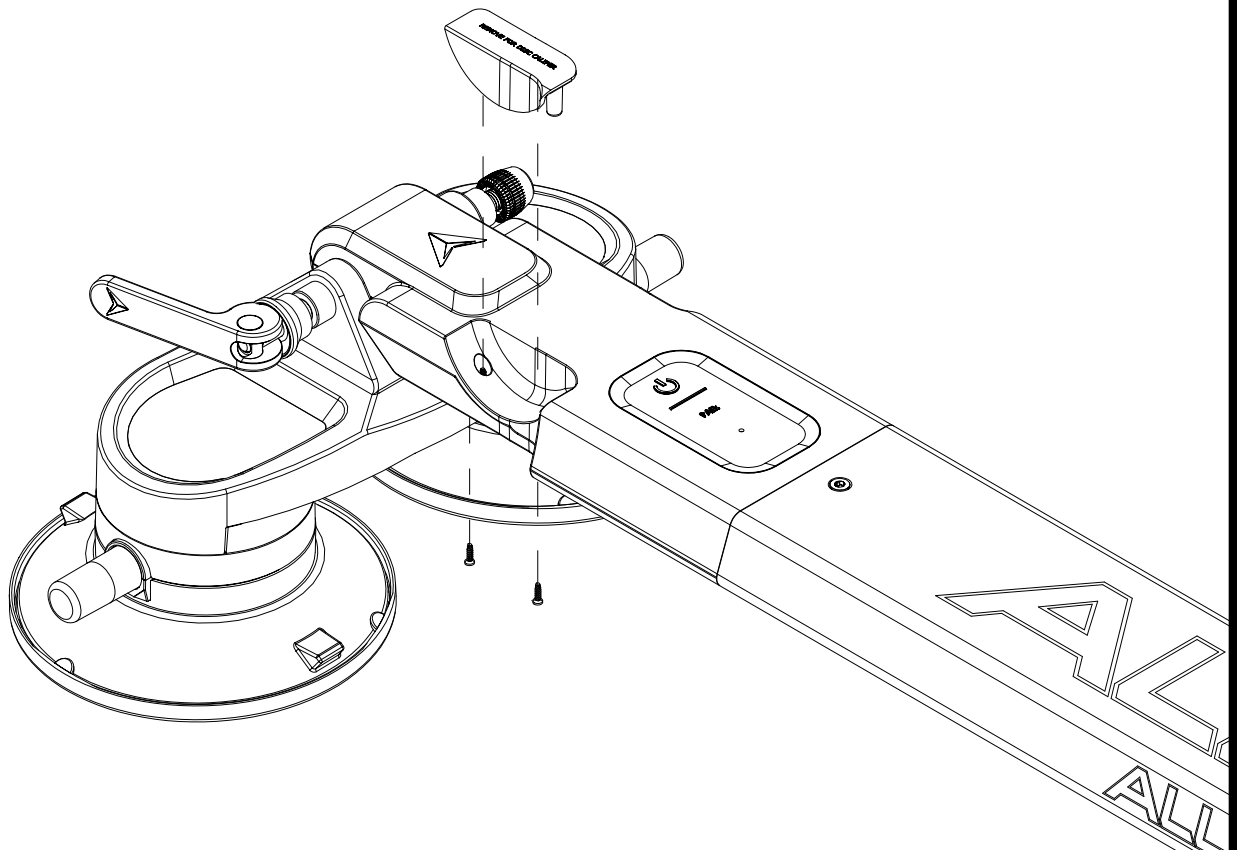

FIGURE 10

**STEP 4:** *For road bikes without Disc Caliper Brakes*

Test mount the Bike to the Rack. With the front tire of the bike removed, lift the bike onto the rack. Insert the front fork on to the axle of the skewer lock as shown below in **Figure 11**. Holding the lever in the “open” position at the end of the skewer, tighten the lock nut on the other end. Once the front fork is secured, flip the lever to the “closed” position and confirm that the skewer is fixed in place and unable to rotate.

**NOTE:** When the lever at the end of the skewer is fully closed the bicycle fork must be completely tight and free of any movement inside of the clamp. The fork mount system functions similar to that of a normal quick release mechanism.

**Tools Required: NONE**

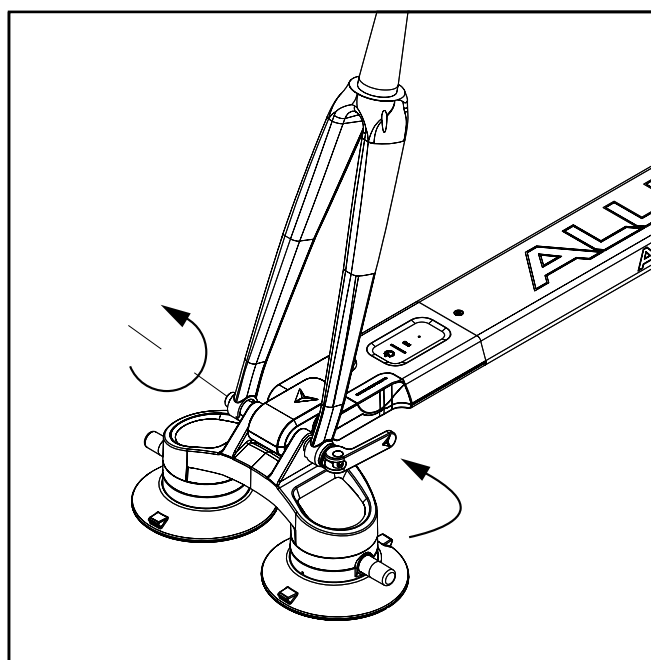
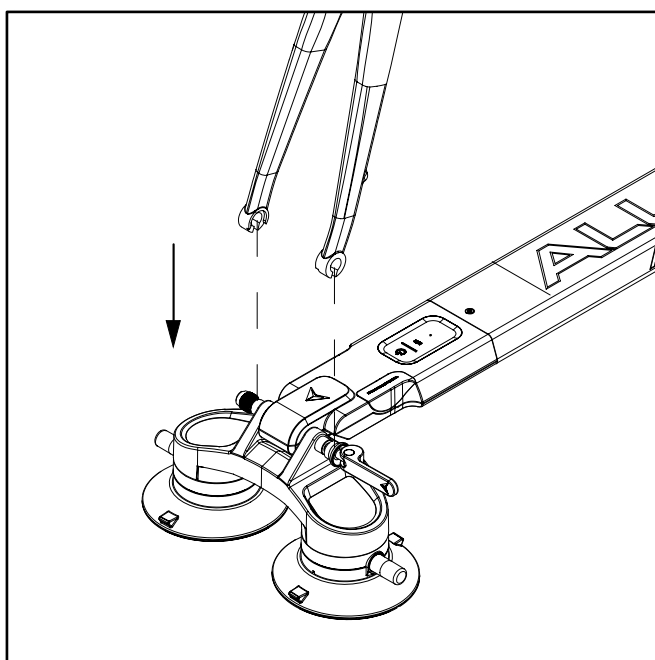

**FIGURE 11**

**NOTE:** If the lever interferes with your bike's fork, a bolt is included for use in its place.

**STEP 5:** *For other bicycles*

Locate the Front Axle Adapter Set, and remove the Adapter Plates (2x) and Cross Tube (1x). Orient the Adapter Plates so that the arrows point forwards. Place the Adapter Plates onto the rack, with the Cross Tube braced between them, as shown in **Figure 12**.

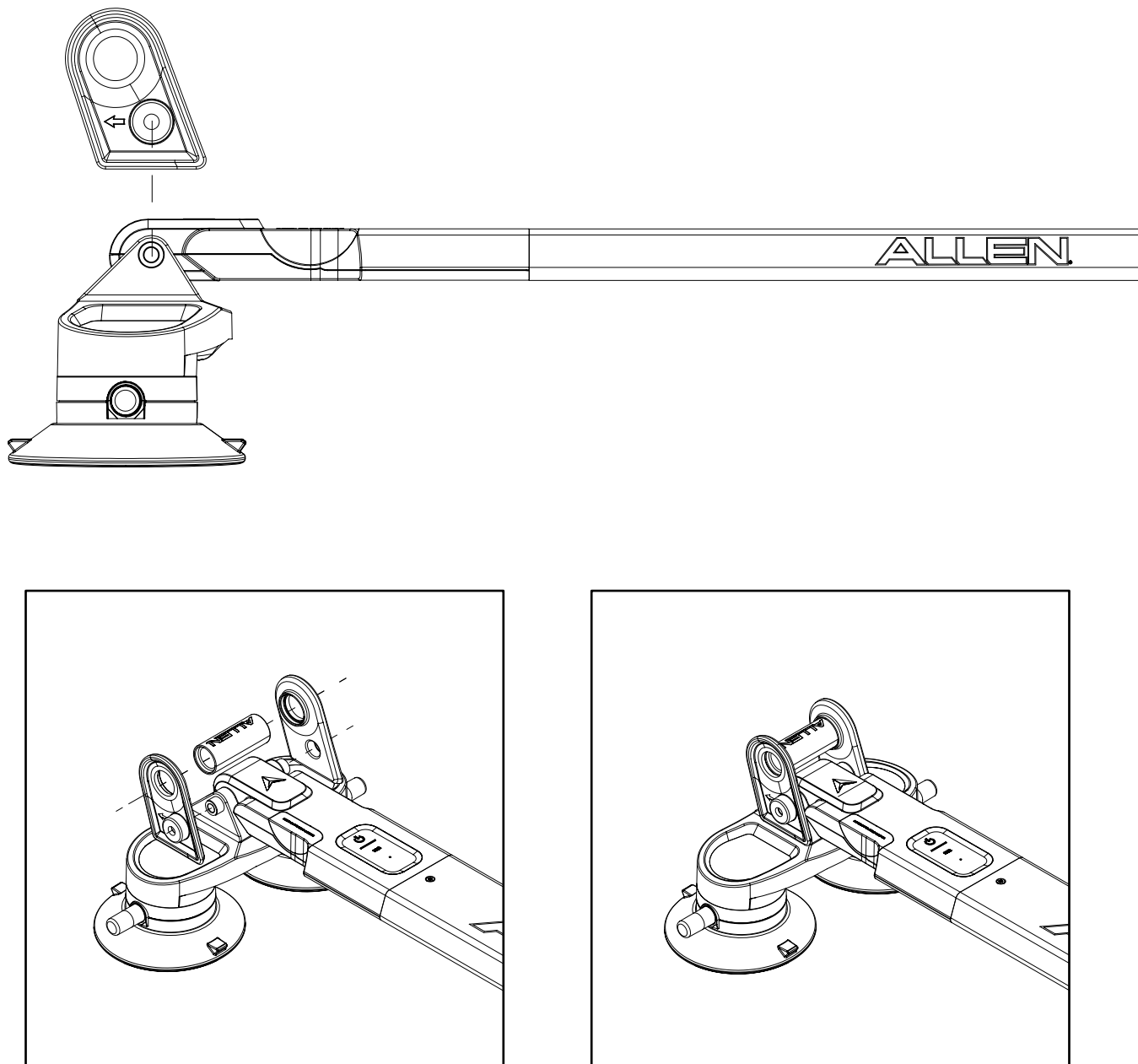

FIGURE 12



**STEP 6:** Attach the adapter assembly to the rack using the Bolt. Holding the bolt in place, tighten the lock nut on the other end. When finished, confirm that the adapter plates are fixed in place and unable to rotate.

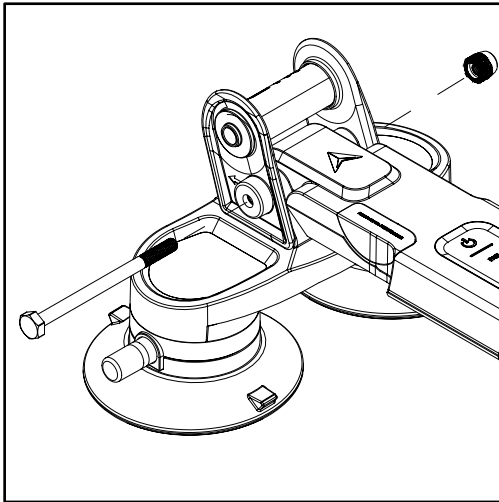
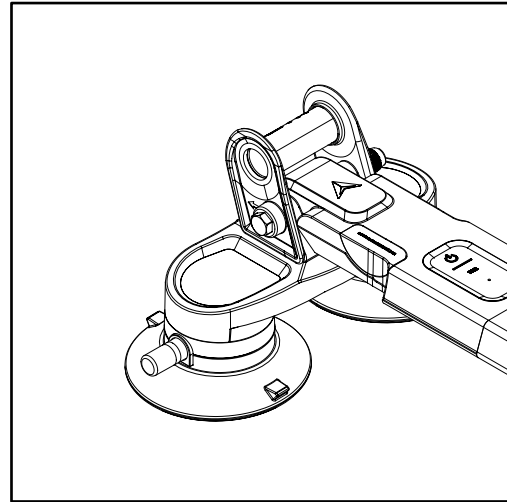

FIGURE 13



**STEP 7:** Locate the pair of Axle Adapters that correspond to your bike's thru-axle, as shown in Figure 14

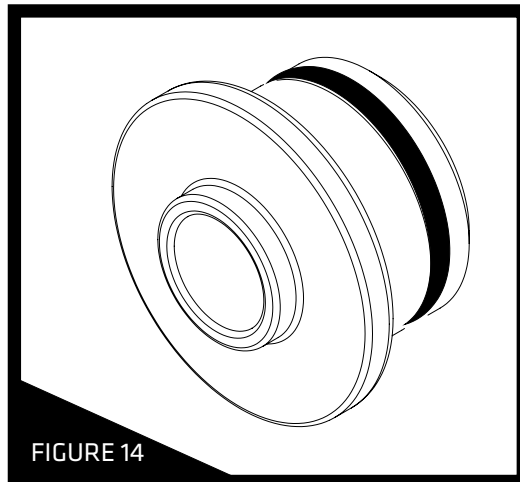

FIGURE 14

**NOTE:** The following pairs of adapters are included:

- 12mm x 100mm [x2]
- 12mm x 110mm [x2]
- 15mm x 100mm [x2]
- 15mm x 110mm [x2]



**STEP 8:** Insert the Adapters into the Cross Tube, so that they are seated flush to the Adaptor Plates, as shown in **Figure 16**.

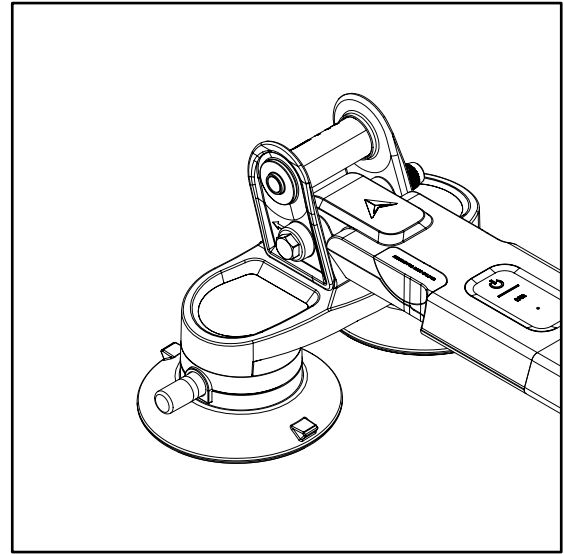
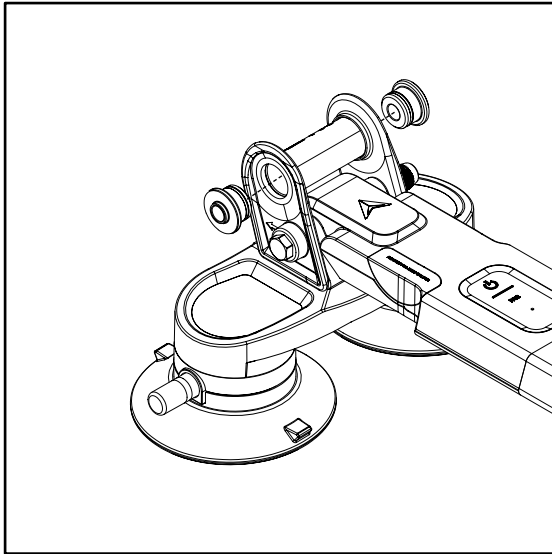

FIGURE 15

**STEP 9:** Test mount the Bike to the Rack. With the bike's front tire removed, put the Thru Axle through the Adapters and Cross Tube and secure, as shown in **Figure 17**. Ensure the Thru Axle is tight to the rack and free of any movement.

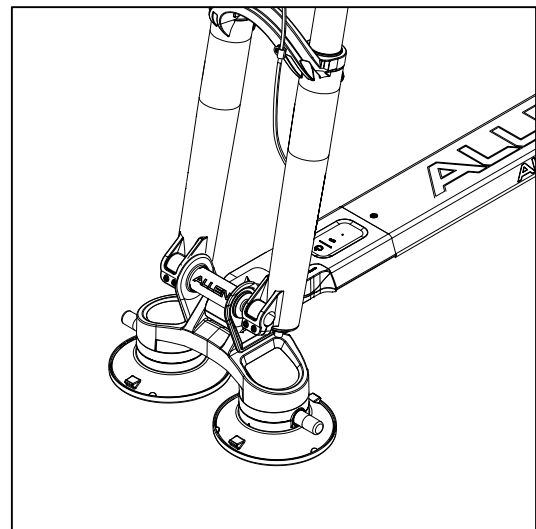
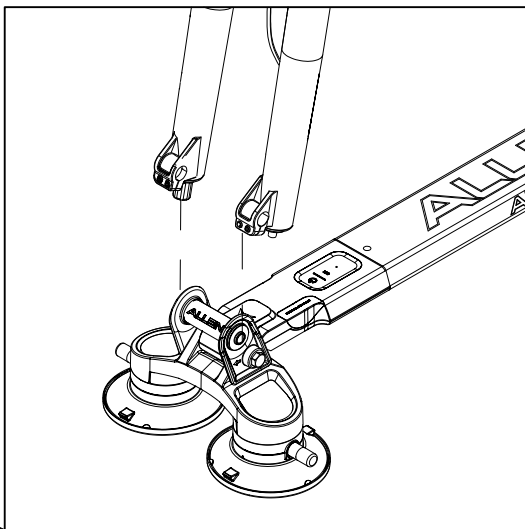

FIGURE 16

**IMPORTANT** Remove Bike from Rack before proceeding with mounting the rack to the car.





### INSTALLATION INSTRUCTIONS

**STEP 1:** Ensure that the vehicle mounting surface(s) are clean and free from dirt or debris for optimal suction cup adhesion prior to installation.

**STEP 2:** Remove the Red Suction Cup Covers from each of the suction cups as shown in **Figure 17**. Ensure that the Suction cups are clean and free from debris.

**NOTE:** It is recommended that the suction cups are cleaned with soap and water periodically to remove any dirt or debris. \* See Section on Rack Maintenance for further instruction.

**NOTE:** Do NOT discard Red Suction Cup Covers.

**Tools Required: NONE**

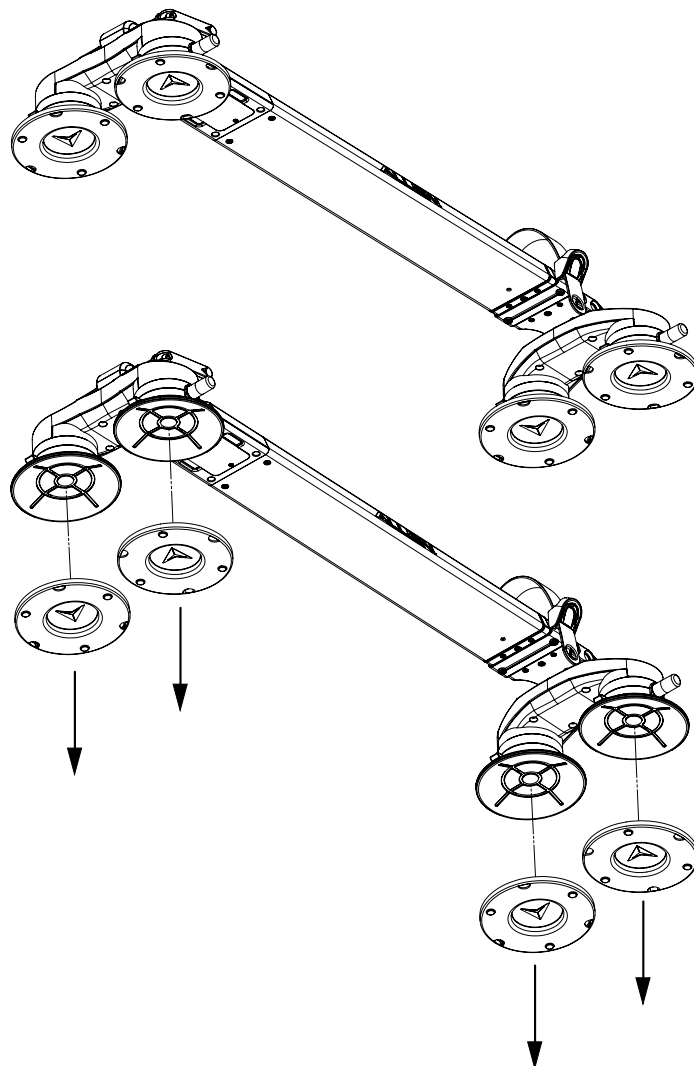

FIGURE 17



**STEP 3** Place the rack onto the vehicle facing forward in the desired location as shown in **Figure 18**. Confirm that the rack is still set to the length that suits the bike, or readjust the rack to the proper setting that was determined previously.

**NOTE:** Be sure to set the length prior to creating a suction seal and securing the rack to the vehicle

**Tools Required: NONE**

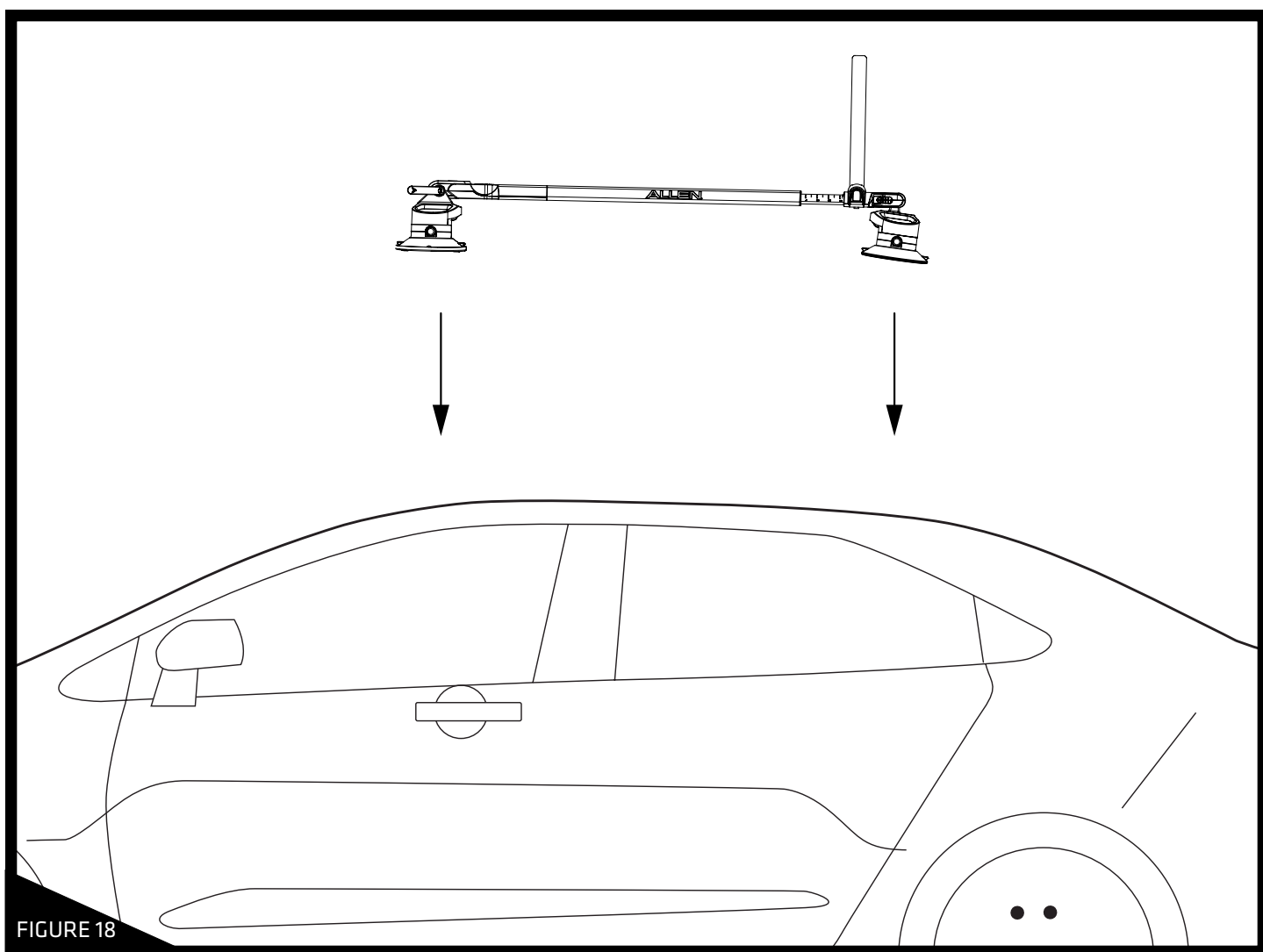

FIGURE 18



**STEP 4:** Create a suction seal by applying downwards pressure to the top of the cup and manually pumping the button on each of the suction cups as shown in **Figure 19**. Once the red barrel indicator on the button is no longer visible, the suction cup is properly sealed to the vehicle.

**NOTE:** Be sure to align the rack parallel with the centerline of the vehicle prior to sealing to mounting surface.

**Tools Required: NONE**

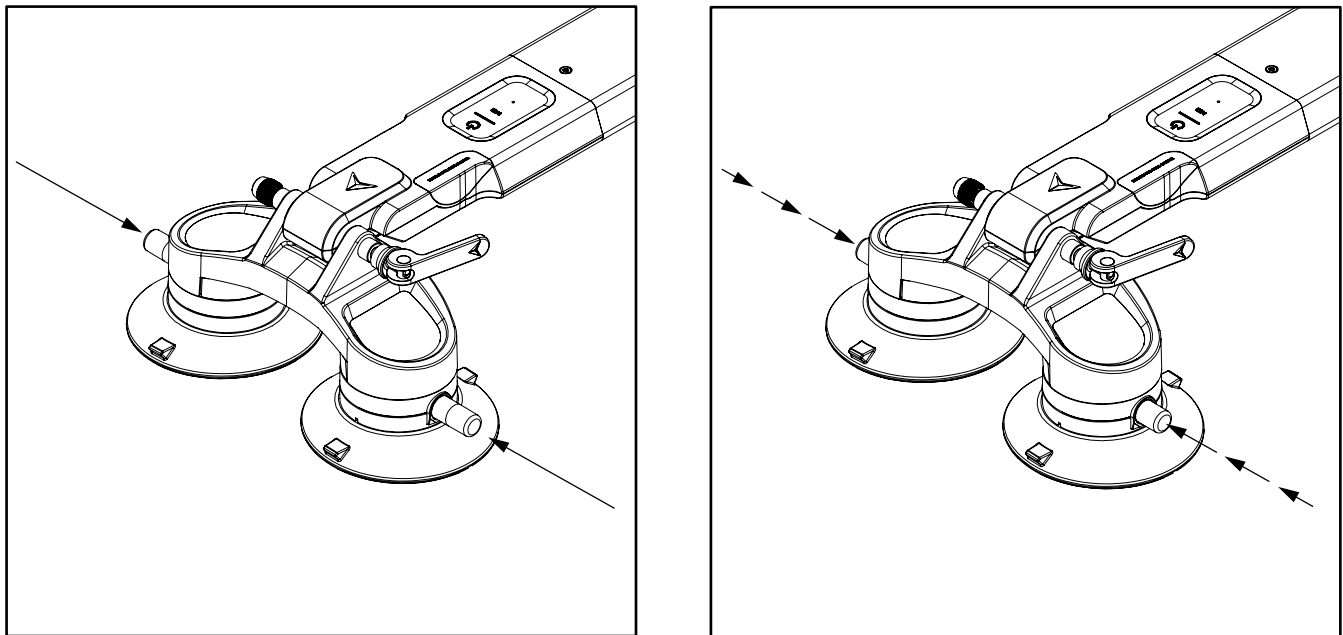

FIGURE 19

**STEP 5** Mount the front fork of the Bike onto the rack, as done previously when testing fit on the ground. This will be either through the rack itself, as demonstrated in **Figure 11**, or through the Adapter Assembly, as demonstrated in **Figure 16**.



**STEP 6:** Place the rear tire into the tire tray and properly align with the Rear Wheel Strap as shown in **Figure 20**. Feed the Rear Wheel Strap through the spokes and feed the end of the strap through the ratchet on the opposite side. Pull down tightly to secure the rear wheel in place.

**IMPORTANT:** Bicycle Cranks should be horizontal when placing the bicycle on to the rack to avoid potential damage to vehicle from pedals.

**NOTE:** To release your bike press the button on the Ratchet Buckle and pull the strap out.

**Tools Required: NONE**

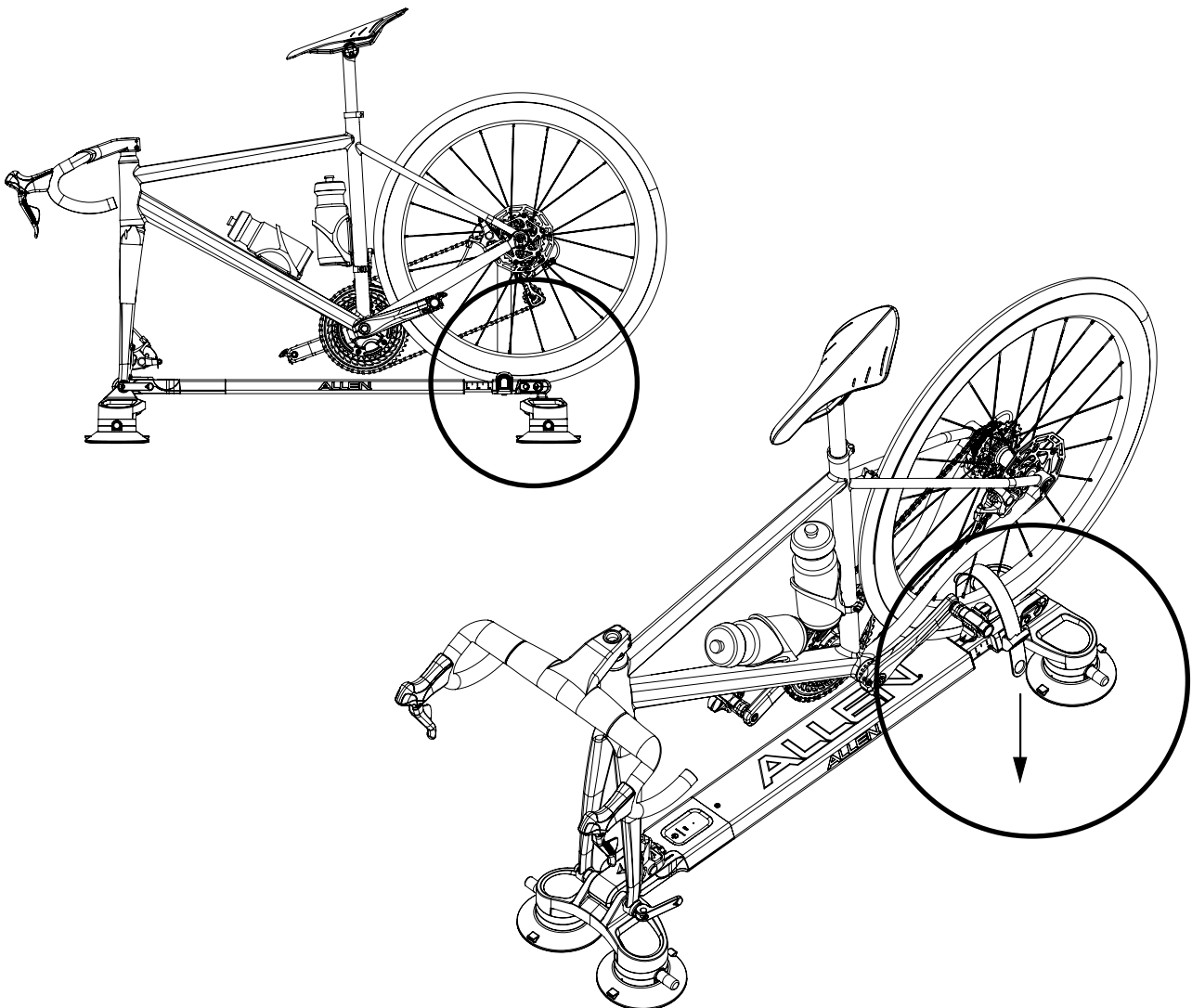
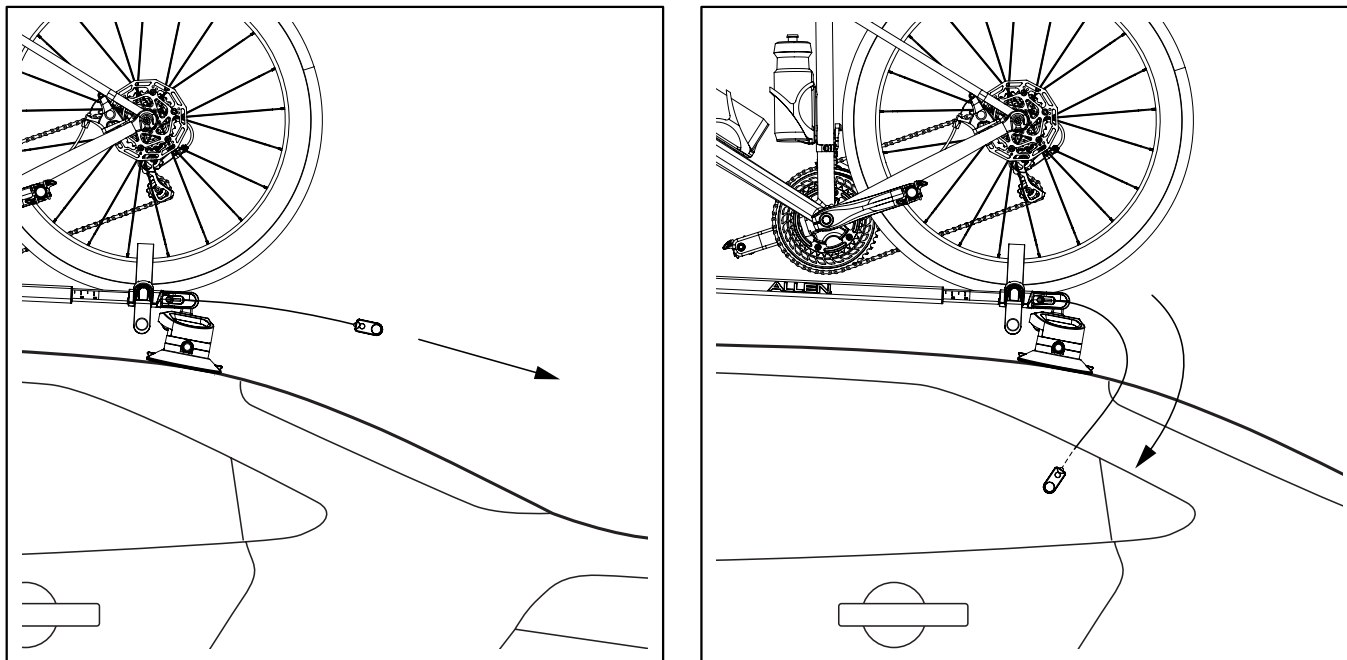

FIGURE 20

**STEP 7:** Secure the Security Tether as shown in **Figure 21**. Pull the Security Tether out using the pull tab on the back left section of the rack until it is long enough to fit inside the door. With the door open place the pull tab inside of the vehicle and close the door.

**NOTE:** Use Caution when closing the door on Security Tether to avoid damaging vehicle.

**Tools Required: NONE**



**FIGURE 21**



**STEP 8:** Remove the Smart Suction Bike Rack from the vehicle as shown in **Figure 22**. Locate the tabs on the outer sealing edge of each suction cup. Lift up on the tabs to release pressure and break the suction seal on each of the four suction cups. The rack is now free to remove from the vehicle. Replace the suction cup covers.

**NOTE:** It is recommended that the Smart Suction Bike Rack be stored indoors to preserve electronic components and increase the longevity of the suction cups.

**Tools Required: NONE**

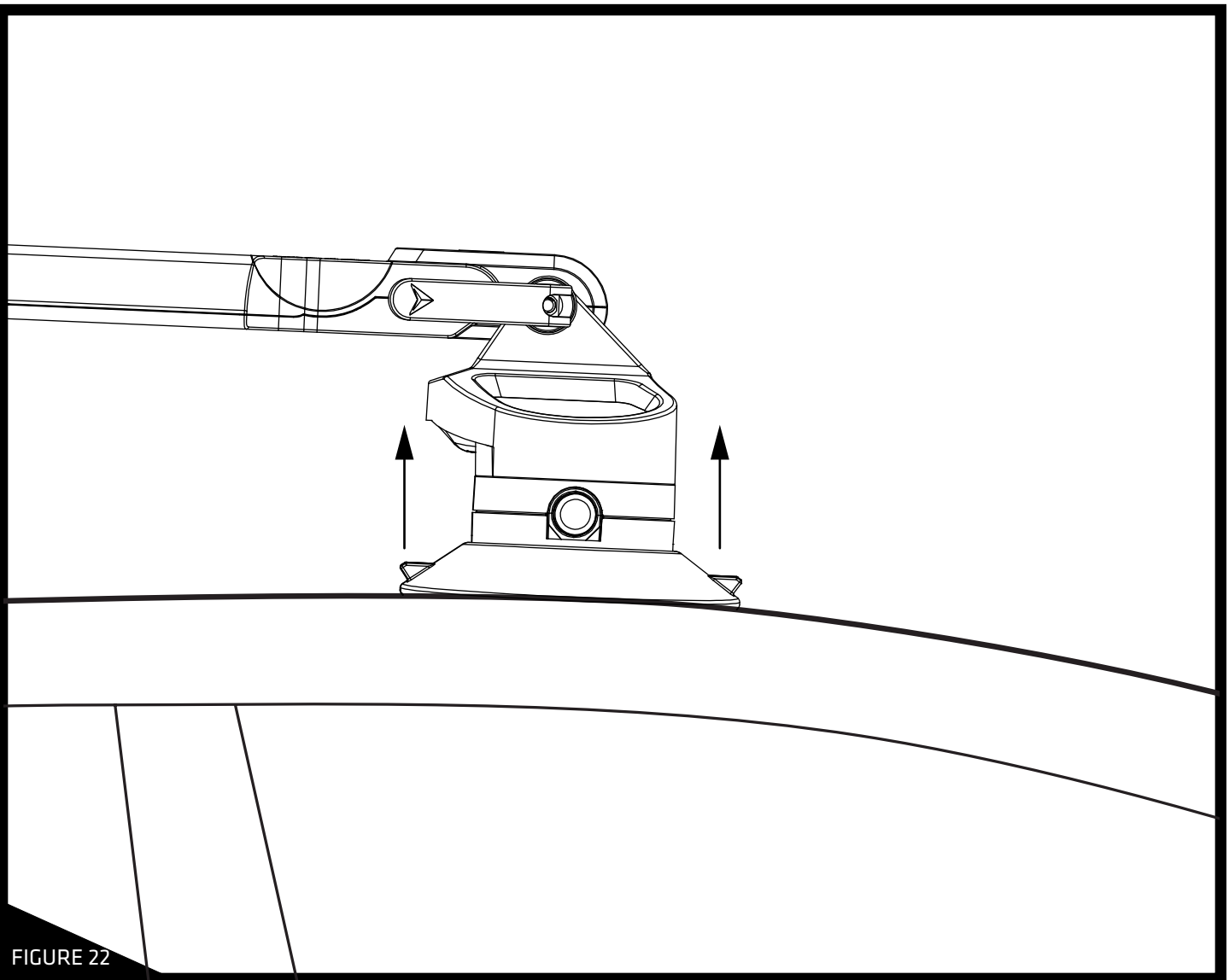

FIGURE 22

**STEP 9:** Turn off the Smart Suction Bike Rack by pressing the power button located on the front prior to storing.



## TROUBLESHOOTING GUIDE

---

PROBLEM	POTENTIAL CAUSES	HOW TO FIX
Slow Leakage	Dry mounting surface or suction cup	Apply water to the mounting surface or the sealing edge of the suction cup
	Cuts or damage on the edge of suction cups	Replace the Suction Cups
	Dirt in pump	Clean the plunger assembly and the inside of the pump cylinder
	Dry pump	Apply a light coating of the lubricant provided to the seal on the tip of the plunger
	Scratches on the inside of the cylinder	Replace the pump
	Dirty suction cup	Clean the mounting surface or move your Rack to a smooth, clean, flat surface, or apply water to the mounting surface or the sealing edge of the suction cups
Severe Leakage	Cuts or damage on the edge of suction cups	Replace the suction cups
	Damaged pump	Replace the pump
	Dirty or uneven mounting surface	Clean the mounting surface or move the rack to a smooth, clean, flat surface
Jammed or Sluggish Pump	Dry pump	Apply a light coating of the lubricant provided to the seal on the tip of the plunger
	Clogged or obstructed valve stem	Remove the obstruction
	Dirt in pump	Clean the plunger assembly and the inside of the pump cylinder
Suction Cup Slipping	Dirty mounting surface	Clean the mounting surface
	Dirty suction cup	Clean the vacuum pad



### RACK MAINTENANCE GUIDE

---

- Before each use inspect and ensure that all screw fasteners are secure.
- Examine the rack before each use for any debris and any missing or damaged parts.
- If debris is present, clean the suction cups with soap and water. Do not clean the suction cups with an abrasive cleaning pad as this can cause damage and compromise their efficacy.
- After each use make sure to replace the suction cup caps
- Store in a dry area when not in use.

#### CLEANING THE PUMP

- To clean the pump, separate the plunger from the pump body
- Apply the included lubricant to the rubber plug at end of plunger

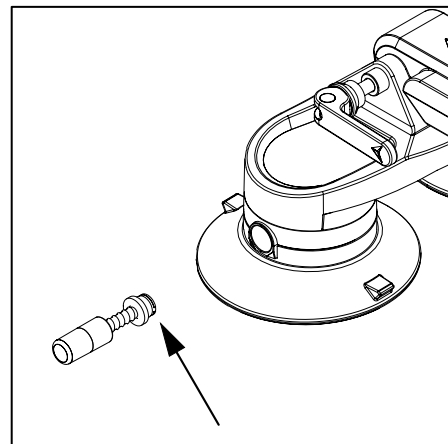
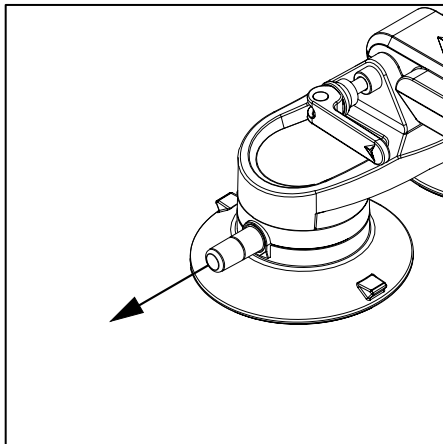

FOR QUESTIONS REGARDING WARRANTY SERVICE, ASSEMBLY,  
INSTALLATION, OR USE, PLEASE CONTACT

ALLEN SPORTS USA

CUSTOMERSERVICE@ALLEN.BIKE

Please note that all returns and exchanges are subject to the return policy of the retailer where the product was originally purchased



# ALLEN

R.A. ALLEN CO., INC. - 500 Beachland Blvd., Suite 1 - 1002; Vero Beach, FL 32963 - USA  
customerservice@allen.bike

www.allen.bike

Product Designed in USA, Made in Shanghai, China